

NOMAD[®]200

SOLAR PANEL

USER GUIDE

 | GOALZERO.

GET TO KNOW YOUR GEAR

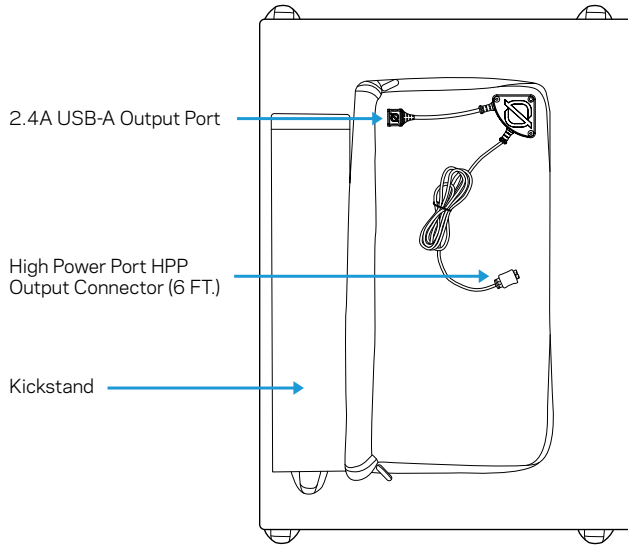

HOW TO CONNECT

Plug the HPP connector into the input port on the Goal Zero Yeti. You'll get the best solar charging experience if you continue to reposition the solar panel throughout the day. Make sure to reference the specs of what you're plugging the Nomad 200 into. On Yeti Portable Power Stations, you'll be checking the input specs.

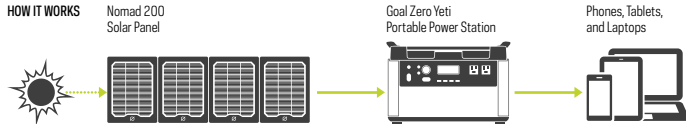

HOW TO CHAIN

To chain multiple Nomad 200 Solar Panels together, you'll need to purchase the 4x High Power Port Combiner Cable (SKU 98061) from Goal Zero.

TECHNICAL SPECIFICATIONS

Charge Times

Goal Zero Yeti 1000X	6-12 hrs
Goal Zero Yeti 1500X	9-18 hrs
Goal Zero Yeti 3000X	18-36 hrs

Solar Panel

Rated Power	200W
Open Circuit Voltage Voc	23.0V
Cell Type	Monocrystalline

Ports

High Power Port (HPP)	14-23V, up to 14A (200W max)
USB-A (output)	5V, 2.4A(12W max)

General

Weight	22 lbs (10.0 kg)
Dimensions (unfolded)	28.2 x 100.7 x 1.0 in (71.6 x 255.8 x 2.5 cm)
Dimensions (folded)	28.2 x 22.3 x 2.0 in (71.6 x 56.6 x 5.0 cm)
Certs	UL CE FCC
Warranty	12 months

Be sure to activate your warranty at [goalzero.com/warranty](https://www.goalzero.com/warranty)

APPRENEZ À CONNAÎTRE VOTRE ÉQUIPEMENT

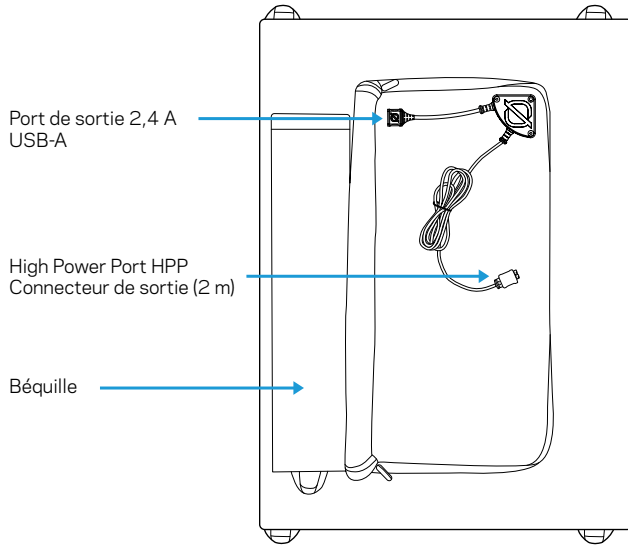

COMMENT LE CONNECTER

Branchez le connecteur HPP dans le port d'entrée du Goal Zero Yeti. Vous obtiendrez la meilleure expérience de charge solaire qui soit en réorientant le panneau solaire tout au long de la journée. Assurez-vous de faire référence aux spécifications de ce que vous connectez à votre Nomad 200. Pour les alimentations portatives Yeti Portable Power Stations, vous devrez vérifier les spécifications d'entrée.

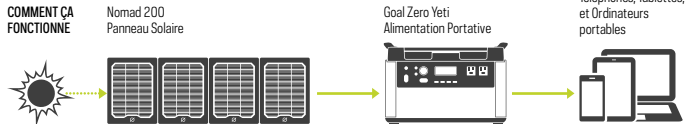

COMMENT CONNECTER EN SÉRIE

Pour connecter plusieurs panneaux solaires Nomad 200 en série, vous devrez acheter le câble combineur 4x High Power Port Combiner Cable (SKU 98061) vendu par Goal Zero.

SPÉCIFICATIONS TECHNIQUES

Temps de charge

Goal Zero Yeti 1000X	6-12 hrs
Goal Zero Yeti 1500X	9-18 hrs
Goal Zero Yeti 3000X	18-36 hrs

Panneau Solaire

Puissance nominale	200 W
Tension en circuit ouvert (V _{oc})	23.0V
Type de batterie	Monocristalline

Ports

High Power Port (HPP)	14-23 V, jusqu'à 14 A (200 W max)
USB-A (sortie)	5 V, 2,4 A (12 W max)

Général

Poids	10,0 kg (22 lb)
Dimensions (déplié)	71,6 x 255,8 x 2,5 cm (28,2 x 100,7 x 1,0 in)
Dimensions (plié)	71,6 x 56,6 x 5,0 cm (28,2 x 22,3 x 2,0 in)
Certifications	
Garantie	12 mois

N'oubliez pas d'activer votre garantie sur goalzero.com/warranty

LERNE DEIN GERÄT KENNEN

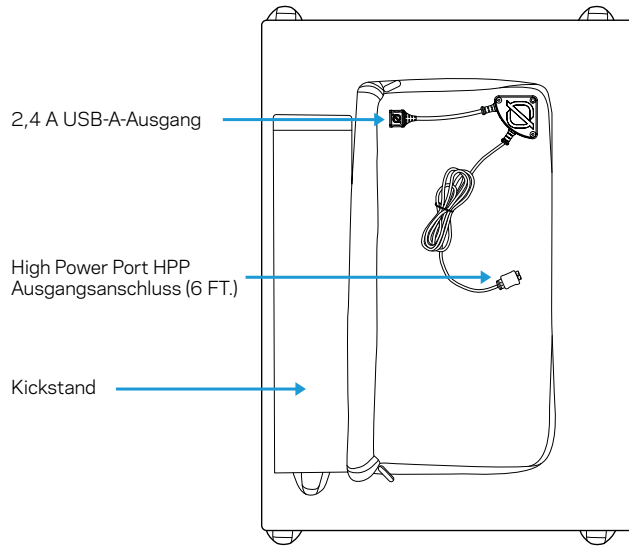

VERBINDE DEIN GERÄT

Stecken Sie den HPP-Stecker in den Eingangsanschluss des Goal Zero Yeti. Die beste Solaraufladung findet statt, wenn Sie das Solarpanel während des Tages immer wieder neu platzieren. Überprüfe unbedingt die Spezifikationen der Anschlüsse, an die du das Nomad 200 ansteckst. An den Yeti Tragbaren Stromversorgungen können Sie die Eingangsspezifikationen prüfen.

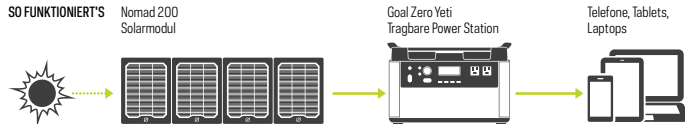

VERKETTE DEIN GERÄT

Um mehrere Nomad 200 Solarmodule miteinander zu verketteten ist der Kauf eines 4x HPP-Kombinationskabels (SKU 98061) von Goal Zero notwendig.

TECHNISCHE SPEZIFIKATIONEN

Ladezeiten

Goal Zero Yeti 1000X	6-12 Std.
Goal Zero Yeti 1500X	9-18 Std.
Goal Zero Yeti 3000X	18-36 Std.

Solarmodul

Nennleistung	200 W
Leerlaufspannung (Voc)	23.0V
Akkutyp	Monokristallin

Anschlüsse

High Power Port (HPP)	14 - 23 V, bis zu 14 A (max. 200 W)
USB-A (Ausgang)	5 V, 2,4 A (12 W max.)

Allgemein

Gewicht	10,0 kg
Abmessungen (auseinandergeklappt):	71,6 x 255,8 x 2,5 cm
Abmessungen (zusammengeklappt):	71,6 x 56,6 x 5,0 cm
Zertifikate	
Garantie	12 Monate

Denke daran, deine Garantie zu aktivieren: goalzero.com/warranty

CONOZCA SU EQUIPO

Puerto de Salida 2.4A
USB-A

High Power Port HPP
Conector de Salida (6 pies)

Soporte

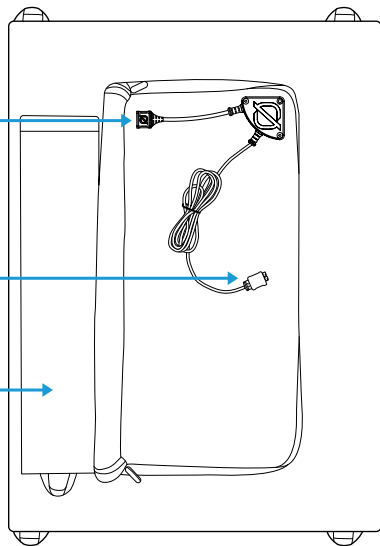

COMO CONECTAR

Enchufe el conector de la aplicación en el puerto de entrada del Goal Zero Yeti. Obtendrá la mejor experiencia de carga solar si continúa repositionando el panel solar durante todo el día. Asegúrese de hacer referencia a las especificaciones de lo que está conectando al Nomad 200. En las estaciones de energía portátil Yeti, debe verificar las especificaciones de entrada.

CÓMO FUNCIONA Nomad 200
Nomad 28 Plus

Goal Zero Yeti
Estación de Energía Portátil

Teléfonos, tabletas
y ordenadores
portátiles



COMO CONECTAR EN SERIE

Para encadenar múltiples paneles solares Nomad 200, deberá comprar el 4x HPP Combiner Cable (SKU 98061) de Goal Zero.

ESPECIFICACIONES TÉCNICAS

Tiempos de Carga

Goal Zero Yeti 1000X	6-12 horas
Goal Zero Yeti 1500X	9-18 horas
Goal Zero Yeti 3000X	18-36 horas

Nomad 28 Plus

Potencia nominal	200W
Voc, voltaje en circuito abierto	23.0V
Tipo de Celda	Monocristalino

Entradas

High Power Port (HPP)	14-23V, hasta 14A (200W máx)
USB-A (salida)	5V, 2.4A(12W máx)

General

Peso	22 lbs (10,0 kg)
Dimensiones (desplegado)	28,2 x 100,7 x 1,0 pulg (71,6 x 255,8 x 2,5 cm)
Dimensiones (plegado)	28,2 x 22,3 x 2,0 pulg (71,6 x 56,6 x 5,0 cm)
Certificaciones	CE FCC
Garantía	12 meses

Asegúrese de activar su garantía en goalzero.com/warranty

FAMILIARIZZA CON LA TUA ATTREZZATURA

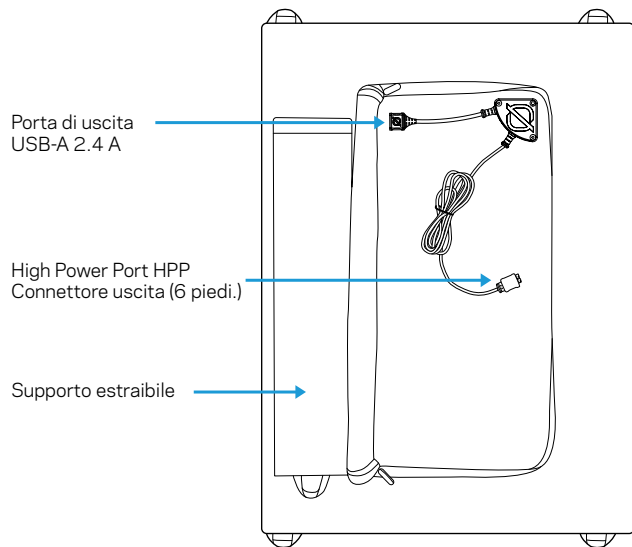

COME COLLEGARLO

Inserire il connettore HPP nella porta di entrata sulla Yeti Goal Zero. Si otterrà la migliore esperienza di ricarica solare se si continua a riposizionare il pannello solare nel corso della giornata. Assicurarsi di indirizzare le specifiche di ciò che si inserisce al bauletto Nomad 200. Sulle centrali elettriche portatili Yeti, si dovrà controllare le specifiche di entrata.

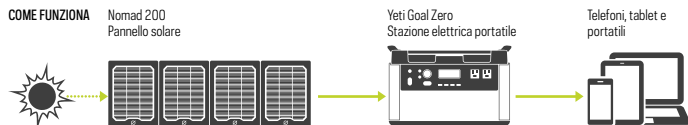

COME CONCATENARE

Per concatenare i multipli pannelli solari Nomad 200 insieme, sarà necessario acquistare il cavo combinatore 4x HPP (SKU 98061) da Goal Zero.

SPECIFICHE TECNICHE

Tempi di carica

Yeti 1000X Goal Zero	6-12 ore
Yeti Goal Zero 1500X	9-18 ore
Yeti 3000X Goal Zero	18-36 ore

Pannello solare

Potenza nominale	200W
Tensione circuito aperto Cov	23.0V
Tipo cella	Monocristallina

Porte

High Power Port (HPP)	14-23V, fino a 14A (200W massimo)
USB-A (uscita)	5V, 2.4A(12W max)

Generale

Peso	22 libbre (10.0 kg)
Dimensioni (distese)	28.2 x 100.7 x 1.0 pollici (71.6 x 255.8 x 2.5 cm)
Dimensioni (distese)	28.2 x 22.3 x 2.0 pollici (71.6 x 56.6 x 5.0 cm)
Certificati	CE FCC
Garanzia	12 mesi

Assicurarsi di attivare la garanzia su goalzero.com/warranty

あなたのギアを知りましょう

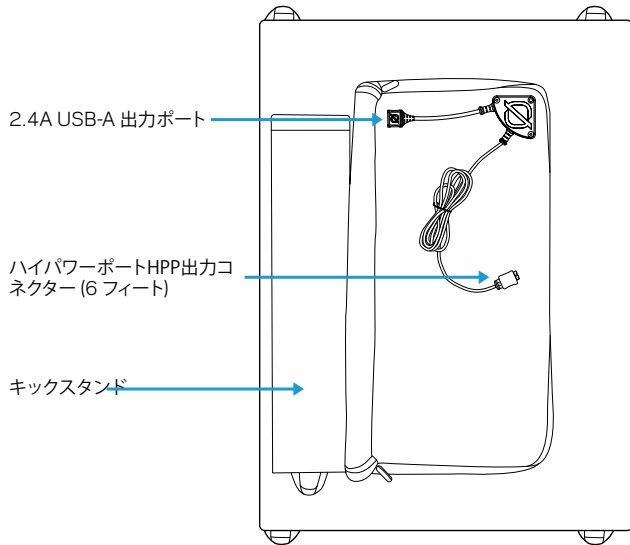

接続方法

HPP コネクタを Goal Zero Yeti の入力ポートに接続します。1日を通してソーラーパネルの角度を太陽に向けて調整し続けると、最適な充電が行えます。Nomad 200 に接続する機器については、製品仕様を必ず参照してください。Yeti ポータブルパワーステーションで、入力仕様を確認します。

使用方法

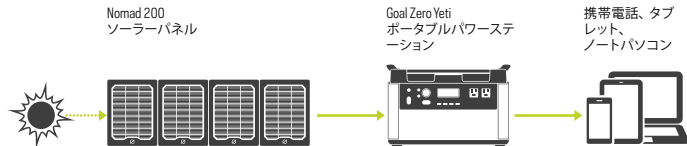

チェーン接続の方法

複数の Nomad 200 ソーラーパネルを連結して使用するには、Goal Zero からアンダーソンコンバイナーケーブル (SKU 98061) を 4 本購入する必要があります。

技術仕様

充電時間

Goal Zero Yeti 1000X	6~12 時間
Goal Zero Yeti 1500X	9~18 時間
Goal Zero Yeti 3000X	18~36 時間

ソーラーパネル

定格出力	200W
開回路電圧 Voc	23.0V
セルタイプ	単結晶
ポート	
ハイパワーポートHPP	14~23V、14A まで (最大 200W)
USB-A (出力)	5V、2.4A (最大 12W)

全般

重量	22 lbs (10.0 kg)
寸法 (使用時)	28.2 x 100.7 x 1.0 インチ (71.6 x 255.8 x 2.5 cm)
寸法 (収納時)	28.2 x 22.3 x 2.0 インチ (71.6 x 56.6 x 5.0 cm)
安全規格	UL CE FCC

保証 12 ヶ月

goalzero.com/warranty にて製品保証を必ず有効にしてください

TUTUSTU LAITTEESEESI

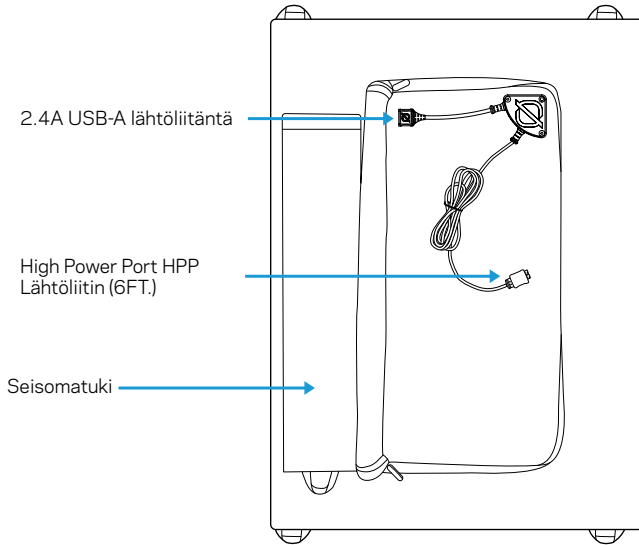

YHTEYDEN MUODOSTAMINEN

Liitä HPP-liitin Goal Zero Yeti -latausaseman tuloliittimeen. Parhaiten aurinkovoimalla lataaminen onnistuu, kun siirtelet välillä aurinkopaneelia päivän mittaan. Tarkastathan aina kaikkien Nomad 200 -akkuun liittämiäsi laitteiden tekniset vaatimukset ennen liittämistä. Kannettavissa Yeti-varavirtalähteissä tarkistetaan sisäisenämenon tiedot.

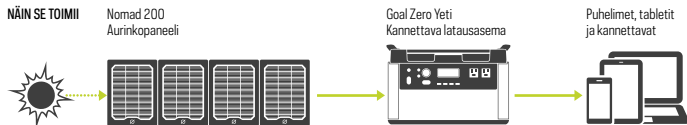

NÄIN KETJUTAT LAITTEEN

Ketjuttaaksesi yhteen useita Nomad 200 -aurinkopaneeleita sinun on hankittava 4x High Power Port -yhdistelmäkaapeli (SKU 98061) Goal Zerolta.

TEKNISET TIEDOT

Latausajat

Goal Zero Yeti 1000X	6-12 tuntia
Goal Zero Yeti 1500X	9-18 tuntia
Goal Zero Yeti 3000X	18-36 tuntia

Aurinkopaneeli

Nimellisteho	200W
Lepojännite	23,0V
Kennotyyppi	Yksikiteinen

Liittimet

High Power Port (HPP)	14-23V, korkeintaan 14A (korkeintaan 200W)
USB-A (ulostulo)	5V, jopa 2,4A (enintään 12W)

Yleistietoja

Paino	10,0 kg
Mitat (avattuna)	71,6 x 255,8 x 2,5 cm
Mitat (kokoon taitettuna)	71,6 x 56,6 x 5,0 cm
Sertifioinnit	CE FCC
Takuu	12 kuukautta

Muista aktivoida takuu osoitteessa goalzero.com/warranty

LEER UW APPARATUUR KENNEN

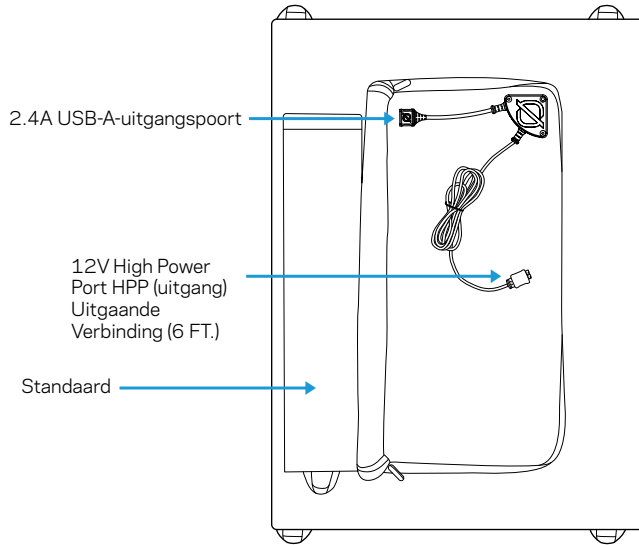

Hoe verbinding te maken

Steek de APP-connector in de ingangspoort van de Goal Zero Yeti power station. U kunt het meeste zonne-energie opladen als u het zonnepaneel de hele dag blijft verplaatsen. Raadpleeg de kenmerken van hetgeen waar u de Ranger 200 Briefcase op aansluit. Op draagbare Yeti-apparaten controleert u de invoerspecificaties.

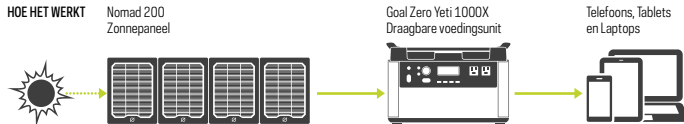

HOE TE BEVESTIGEN

Om meerdere Nomad 200 zonnepanelen aan elkaar te koppelen, moet men de 4x High Power Port Combiner Cable (SKU 98061) van Goal Zero aanschaffen.

TECHNISCHE KENMERKEN

Oplaadtijden

Goal Zero Yeti 1000X	6 tot 12 uur
Goal Zero Yeti 1500X	9-18 uur
Goal Zero Yeti 3000X	18-36 uur

Zonnepaneel

Nominaal vermogen	200W
Open-circuit spanning	23.0V
Celtype	Monokristallijn

Poorten

12V High Power Port HPP (uitgang)	14-23V, tot aan 14A (200W max)
USB- A Uitvoer	USB 5 V, tot 2,4 A (12 W)

Algemeen

Gewicht	22 lbs (10.0 kg)
Afmetingen (opgevouwen)	28,2 x 100,7 x 1,0 in (71,6 x 255,8 x 2,5 cm)
Afmetingen (gevouwen)	28,2 x 22,3 x 2,0 in (71,6 x 56,6 x 5,0 cm)
Certificaten	CE FCC
Garantie	12 maanden

Zorg ervoor dat u uw garantie activeert op goalzero.com/warranty

LÄR KÄNNA DIN UTRUSTNING

2,4A USB-A uttagsport

High Power Port HPP
Uttagskontakt (6 fot)

Utfällbart
stödben

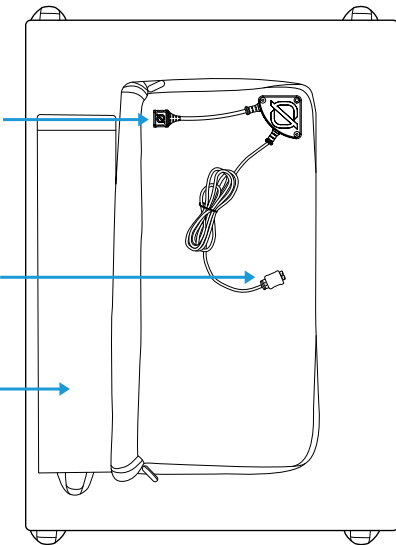

HUR MAN ANSLUTER

Anslut HPP-kontakten till anslutningsporten på Goal Zero Yeti. Du får den bästa solladdningen genom att flytta solpanelen under dagen. Kontrollera specifikationerna för det ska ansluta Nomad 200 till. På Yeti portabel kraftstation ska du kontrollera specifikationerna för ingående anslutning.

HUR DEN
FUNKERAR

Nomad 200
Solpanel

Goal Zero Yeti
Portabel kraftstation

Telefoner, surfplattor
och bärbara datorer



HUR MAN SERIEKOPPLAR

För att seriekoppla flera Nomad 200 solpaneler måste du köpa 4x High Power Port kombinationskablar (SKU 98061) från Goal Zero.

TEKNISKA SPECIFIKATIONER

Laddningstider

Goal Zero Yeti 1000X	6-12 h
Goal Zero Yeti 1500X	9-18 h
Goal Zero Yeti 3000X	18-36 h

Solpanel

Nominell effekt	200W
Öppen kretsspänning Voc	23V
Celltyp	Monokristallin

Portar

High Power Port (HPP)	14-23V, upp till 14A (200W max)
USB-A (uteffekt)	5V, upp till 2,4A (12W max)

Allmänt

Vikt	10 kg (22 lbs)
Mått (utfälld)	71,6 x 255,8 x 2,5 cm (28,2 x 100,7 x 1 tum)
Mått (hopfäld)	71,6 x 56,6 x 5 cm (28,2 x 22,3 x 2 tum)
Certifikat	CE FCC
Garanti	12 månader

Se till att aktivera din garanti på goalzero.com/warranty

GOAL ZERO HEADQUARTERS

675 West 14600 South
Bluffdale, UT 84065
1-888-794-6250
Designed in the U.S.A.
Made in China

Nomad is a trademark of Goal Zero.

This equipment has been tested and found to comply with the limits for a Class B digital device, pursuant to part 15 of the FCC Rules. These limits are designed to provide reasonable protection against harmful interference in a residential installation. This equipment generates, uses and can radiate radio frequency energy and, if not installed and used in accordance with the instructions, may cause harmful interference to radio communications. However, there is no guarantee that interference will not occur in a particular installation. If this equipment does cause harmful interference to radio or television reception, which can be determined by turning the equipment off and on, the user is encouraged to try to correct the interference by one or more of the following measures:

- Reorient or relocate the receiving antenna.
- Increase the separation between the equipment and receiver.
- Connect the equipment into an outlet on a circuit different from that to which the receiver is connected.
- Consult the dealer or an experienced radio/TV technician for help.

This device complies with part 15 of the FCC Rules. Operation is subject to the following two conditions: (1) This device may not cause harmful interference, and (2) this device must accept any interference received, including interference that may cause undesired operation.

GOALZERO.COM

JG011321V2